

FRENO LINKBOLT B

Safety factor 5:1

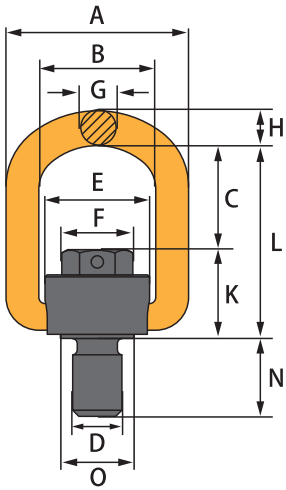

For thread holes suitable for JIS (Japanese Industrial Standard) eye bolts. Use type A for size M20 or smaller. Special specifications like different bolt type or length are available. Please contact us for details.

Product Code	WLL (t)	Bolt Size D	Pitch (mm)	Dimensions (mm)											Tightening Torque (Nm) Min - Max	Weight (kg)
				A	B	C	E	F	G	H	K	L	N	O		
B-24	0.95	M24	3	89	57	52	51	30	13	17	43	95	38	36	18 - 29	0.95
B-30	1.5	M30	3.5	89	57	52	51	30	13	17	45	97	45	43	20 - 39	1.1
B-36	2.3	M36	4	126	82	72	80	46	19	23	63	135	55	51	34 - 49	3.1
B-42	3.4	M42	4.5	126	82	72	80	46	19	23	65	137	65	59	49 - 98	3.4
B-48	4.3	M48	5	126	82	72	80	46	19	23	65	137	70	68	59 - 147	3.7
B-64	9.0	M64	6	179	117	94	111	65	27	32	91	184	90	89	88 - 392	9.6
BB-64	15.0	M64	6	246	152	115	145	85	35	43	120	235	90	110	137 - 785	17.4
B-80	15.0	M80	6	246	152	115	145	85	35	43	120	235	105	110	137 - 785	19.2
B-100	15.0	M100	6	246	152	115	145	85	35	43	120	235	130	130	137 - 785	23.1
MB-64	20.0	M64	6	272	174	127	163	85	42	49	148	275	82	150	196 - 785	27.1
MB-80	20.0	M80	6	272	174	127	163	85	42	49	148	275	105	150	196 - 785	29.0
MB-100	20.0	M100	6	272	174	127	163	85	42	49	148	275	130	150	196 - 785	32.7

* B-100, MB-64, MB-80 and MB-100 are non-stock items. Please inquire for availability and delivery dates.

FRENO LINKBOLT C (Weld-on type)

Safety factor 5:1

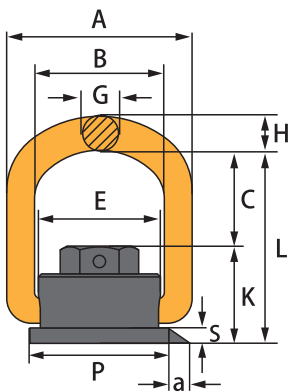

Welding (arc welding) shall be performed by a qualified person. Welding should be performed all around the base of the link bolt with the specified leg length (a). Use a welding rod that meets JIS Z3212 D5016 (LB-52A or equivalent). After welding, inspect the weld for cracks using penetrant test, magnetic particle test, etc.

Product Code	WLL (t)	Dimensions (mm)											Weight (kg)
		a	A	B	C	E	G	H	K	L	P	S	
C-10	0.5	3	60	42	32	40	8	11	32	64	45	5	0.31
C-16	1.6	5	89	57	52	51	13	17	48	100	60	7	0.98
C-24	4.0	8	126	82	71	80	19	23	71	142	85	10	3.1
C-36	8.0	12	179	117	94	111	27	32	99	192	120	14	8.5

For a table of working load limits depending on the lifting method please see page 10.