

NOTES : UNLESS OTHERWISE SPECIFIED

1. ALL DIMENSIONS ARE IN MILLIMETERS.
2. TO PREVENT IRREGULAR WINDING OF THE WIRE ROPE AROUND THE DRUM, KEEP THE FLEETANGLE 2 DEGREES OR LESS. PLEASE INSTALL THE PULLEY 10mm OR MORE AWAY FROM THE DRUM ON THE CENTER LINE OF THE DRUM.
3. THE VALUE OF SPECIFIED "WIRE ROPE TENSION" ON THIS DRAWING IS FOR THE STANDARD LAYER OR LESS. THE VALUE OF THE "WIRE ROPE TENSION" MUST BE DECREASED ACCORDANCE WITH THE RATIO OF THE ACTUAL WINDING LAYERS, IF IT EXCEEDED.

Specifications			
Load Rating Wire Rope Tension	980N (= 100kgf) Standard layer or less	Handle Force	Wire rope : Standard Layer : Handle Force φ 3mm : 8-Layer : 58N (= 5.9kgf) φ 4mm : 6-Layer : 57N (= 5.8kgf) φ 5mm : 5-Layer : 58N (= 5.9kgf)
Drum Capacity	φ 3mm ... 40.0m ; 12-Layer Windings φ 4mm ... 25.0m ; 9-Layer Windings φ 5mm ... 15.5m ; 7-Layer Windings	Wire Rope Tension 980N	Standard Accessories One Handle
Gear Ratio	1 / 4.1	Painting	Epoxy-Based Powder Coating, Single Coat Painting Color Drum : RAL 9004 Frame : RAL 2009
Handle Length	210mm		
Weight	2.7kg (Winch + Handle)		

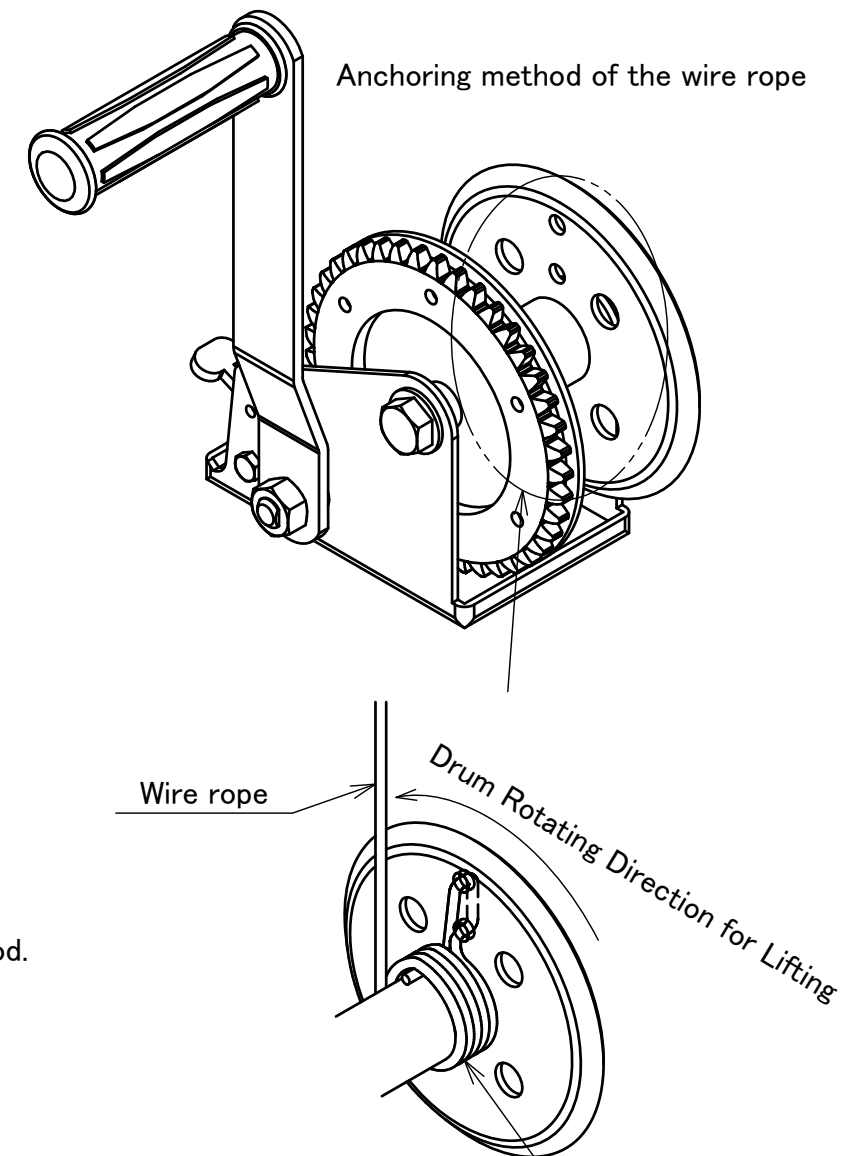
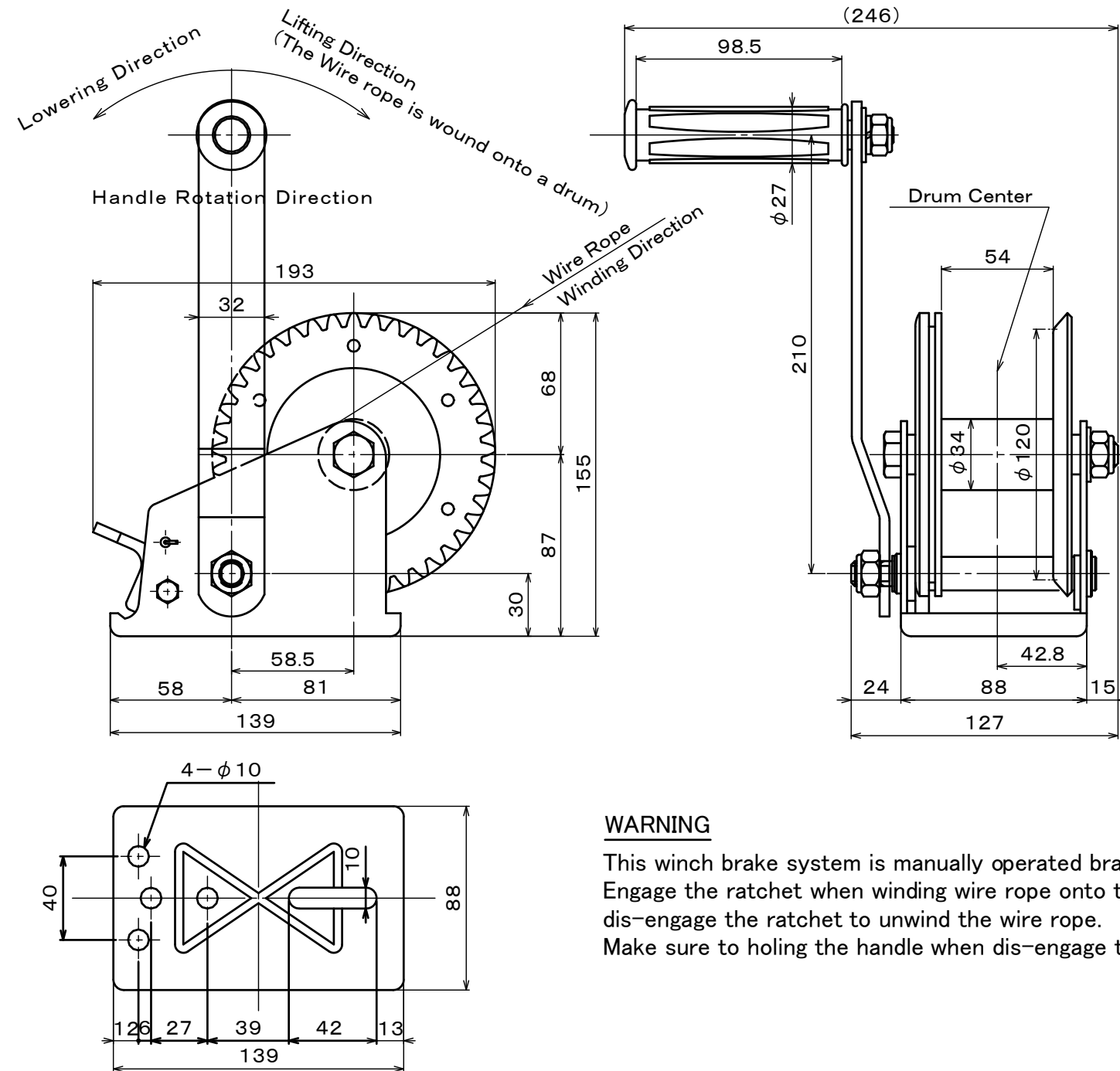

Keep 5 wraps or more of wire rope wound onto the drum at all times as the extra maintenance winding.

4 ×		図面番号 / DRAWING No.	改訂番号 / REVISION No.	お客様 / CUSTOMER	符号 / MARK	項目 / PARTICULARS	材料 / MATERIAL	数量 / QTY	単体重量 (kg) / TOTAL WEIGHT	備考 / REMARKS
3 ×		PM1-230915-01E	01							
2 ×		承認 / APPROVED	検図 / CHECKED	作成 / DRAWN	図面名 / TITLE		投影法 / PROJECTION METHOD	MAXPULL MACHINERY & ENGINEERING CO., LTD.		
1 ×		設計課 23.09.15 米澤	設計課 23.09.15 松嶺	設計課 23.09.15 平形	MINI MAXPULL WINCH MODEL PM-100		第三角法 THIRD ANGLE PROJECTION 尺度 / SCALE	マックスプル工業株式会社		
改訂 / REVISION							台数 / QTY			