

FRENO LINKBOLT A

Safety factor 5:1

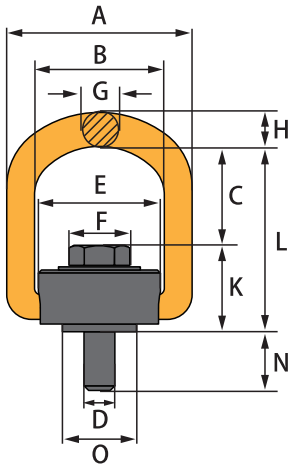

A [Metric Regular]

3 times higher working load limit (WLL) compared to a conventional JIS eye bolt of the same bolt size.
Special specifications like different bolt type or length are available. Please contact us for further details.

Product Code	WLL (t)	Bolt Size D	Pitch (mm)	Dimensions (mm)											Tightening Torque (Nm) Min - Max	Weight (kg)
				A	B	C	E	F	G	H	K	L	N	O		
A-8	0.3	M8	1.25	60	42	34	40	13	8	11	27	61	14	24	8 - 15	0.25
A-10	0.5	M10	1.5	60	42	33	40	17	8	11	28	61	19	24	12 - 20	0.26
A-12	0.8	M12	1.75	89	57	56	51	19	13	17	39	95	19	37	18 - 29	0.81
A-14	1.2	M14	2	89	57	55	51	22	13	17	40	95	24	37	25 - 40	0.83
A-16	1.6	M16	2	89	57	54	51	24	13	17	41	95	24	37	30 - 49	0.85
A-18	2.3	M18	2.5	126	82	79	80	27	19	23	55	134	32	51	40 - 65	2.6
A-20	2.8	M20	2.5	126	82	78	80	30	19	23	56	134	32	51	49 - 78	2.6
A-22	3.1	M22	2.5	126	82	77	80	32	19	23	57	134	37	51	50 - 170	2.7
A-24	3.7	M24	3	126	82	76	80	36	19	23	58	134	37	51	59 - 196	2.7
A-27	5.0	M27	3	179	117	105	111	41	27	32	77	182	45	73	78 - 245	7.1
A-30	6.3	M30	3.5	179	117	103	111	46	27	32	79	182	50	73	108 - 294	7.2
A-33	7.0	M33	3.5	179	117	101	111	50	27	32	81	182	55	73	150 - 330	7.3
A-36	8.0	M36	4	179	117	99	111	55	27	32	83	182	60	73	177 - 392	7.6
A-42	10.0	M42	4.5	220	142	127	136	65	31	39	102	229	65	95	230 - 450	13.2
A-48	12.0	M48	5	220	142	123	136	75	31	39	106	229	69	95	294 - 585	13.8
A-48L	15.0	M48	5	246	152	120	145	75	35	43	112	232	78	95	294 - 585	15.6

* A-48L is a non-stock item. Please inquire for availability and delivery dates.

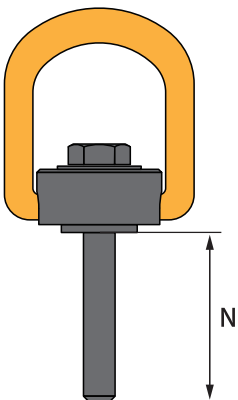

A [Long Bolt]

Same WLL as FRENO LINKBOLT A

Product Code	WLL (t)	N (mm)
A-16 N34	1.6	34
A-16 N39	1.6	39
A-16 N49	1.6	49
A-16 N69	1.6	69
A-20 N42	2.8	42
A-20 N47	2.8	47
A-20 N57	2.8	57
A-20 N67	2.8	67
A-24 N47	3.7	47
A-24 N67	3.7	67
A-24 N87	3.7	87

* The above are stock sizes.
Other lengths available on request.

A [Fine Thread] * Please check availability.

Same WLL as FRENO LINKBOLT A

Product Code	WLL (t)	Pitch (mm)
A-8 P1	0.3	1
A-10 P1.25	0.5	1.25
A-12 P1.25	0.8	1.25
A-14 P1.5	1.2	1.5
A-16 P1.5	1.6	1.5
A-18 P1.5	2.3	1.5
A-20 P1.5	2.8	1.5
A-22 P1.5	3.1	1.5
A-24 P2	3.7	2
A-27 P2	5.0	2
A-30 P2	6.3	2
A-33 P2	7.0	2
A-36 P3	8.0	3

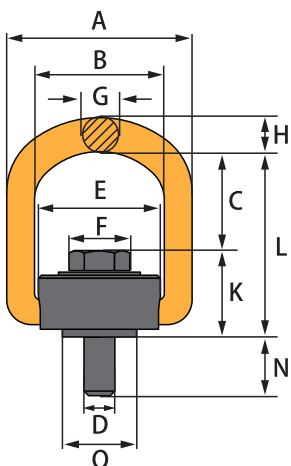

A [Inch Whitworth] * Please check availability.

Product Code	WLL (t)	Bolt Size D	Dimensions (mm)											Tightening Torque (Nm) Min - Max	Weight (kg)
			A	B	C	E	F	G	H	K	L	N	O		
A-W3/8	0.35	W3/8	60	42	34	40	17	8	11	27	61	19	24	12 - 20	0.25
A-W1/2	0.8	W1/2	89	57	55	51	21	13	17	40	95	19	37	18 - 29	0.81
A-W5/8	1.4	W5/8	89	57	53	51	26	13	17	42	95	24	37	30 - 49	0.84
A-W3/4	2.2	W3/4	126	82	78	80	32	19	23	56	134	32	51	49 - 78	2.6
A-W7/8	3.0	W7/8	126	82	76	80	35	19	23	58	134	37	51	50 - 170	2.7
A-W1	3.7	W1	126	82	73	80	41	19	23	61	134	37	51	59 - 196	2.8
A-W1 1/4	6.0	W1 1/4	179	117	100	111	50	27	32	82	182	50	73	108 - 294	7.3
A-W1 1/2	8.0	W1 1/2	179	117	95	111	58	27	32	87	182	60	73	177 - 392	7.7
A-W2	12.0	W2	220	142	117	136	77	31	39	112	229	69	95	294 - 585	14.0

FRENO LINKBOLT A

Safety factor 5:1

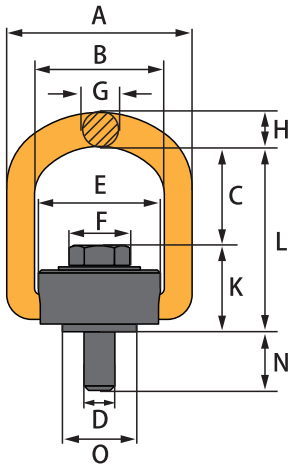

A [Inch Unified] * Please check availability.

Product Code	WLL (t)	Bolt Size D	Dimensions (mm)											Tightening Torque (Nm) Min - Max	Weight (kg)
			A	B	C	E	F	G	H	K	L	N	O		
A-3/8-16UNC	0.35	3/8-16UNC	60	42	34	40	17	8	11	27	61	19	24	12 - 20	0.25
A-1/2-13UNC	0.8	1/2-13UNC	89	57	55	51	21	13	17	40	95	19	37	18 - 29	0.81
A-5/8-11UNC	1.4	5/8-11UNC	89	57	53	51	26	13	17	42	95	24	37	30 - 49	0.84
A-3/4-10UNC	2.2	3/4-10UNC	126	82	78	80	32	19	23	56	134	32	51	49 - 78	2.6
A-7/8-9UNC	3.0	7/8-9UNC	126	82	76	80	35	19	23	58	134	37	51	50 - 170	2.7
A-1-8UNC	3.7	1-8UNC	126	82	73	80	41	19	23	61	134	37	51	59 - 196	2.8
A-1 1/4-7UNC	6.0	1 1/4-7UNC	179	117	100	111	50	27	32	82	182	50	73	108 - 294	7.3
A-1 1/2-6UNC	8.0	1 1/2-6UNC	179	117	95	111	58	27	32	87	182	60	73	177 - 392	7.7
A-2-4.5UNC	12.0	2-4.5UNC	220	142	117	136	77	31	39	112	229	69	95	294 - 585	14.0

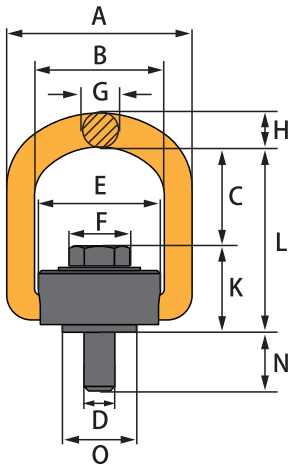

A [Oil-free Washer] * Please check availability.

For applications of constant inverting and lifting, we recommend the FRENO LINKBOLT with oil-free washer. The washer ensures smooth rotation even under load.

Product Code	WLL (t)	Bolt Size D	Pitch (mm)	Dimensions (mm)											Tightening Torque (Nm) Min - Max	Weight (kg)
				A	B	C	E	F	G	H	K	L	N	O		
A-12W	0.8	M12	1.75	89	57	55	51	19	13	17	40	95	18	37	18 - 29	0.82
A-16W	1.6	M16	2	89	57	53	51	24	13	17	42	95	23	37	30 - 49	0.85
A-20W	2.8	M20	2.5	126	82	77	80	30	19	23	57	134	31	51	49 - 78	2.6
A-24W	3.7	M24	3	126	82	75	80	36	19	23	59	134	36	51	59 - 196	2.7
A-30W	6.3	M30	3.5	179	117	101	111	46	27	32	81	182	48	73	108 - 294	7.3

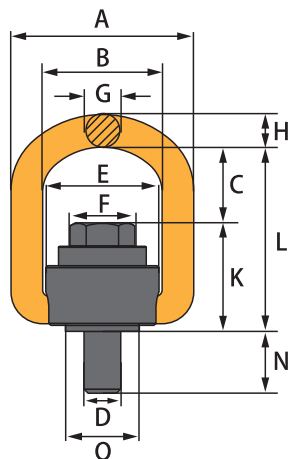

A [Bearing]

For applications of constant inverting and lifting, the FRENO LINKBOLT with an in-built bearing is the best choice. The bearing ensures smooth rotation even under load.

Product Code	WLL (t)	Bolt Size D	Pitch (mm)	Dimensions (mm)											Tightening Torque (Nm) Min - Max	Weight (kg)
				A	B	C	E	F	G	H	K	L	N	O		
A-12S	0.8	M12	1.75	89	57	43	51	19	13	17	52	95	21	37	18 - 29	0.96
A-16S	1.4	M16	2	89	57	41	51	24	13	17	54	95	26	37	30 - 49	1.0
A-20S	2.6	M20	2.5	126	82	62	80	30	19	23	72	134	31	51	49 - 78	2.9
A-24S	3.7	M24	3	126	82	60	80	36	19	23	74	134	36	51	59 - 196	3.7
A-30S	6.0	M30	3.5	179	117	80	111	46	27	32	102	182	47	73	108 - 294	8.1
A-36S	7.5	M36	4	179	117	76	111	55	27	32	106	182	61	73	177 - 392	8.5
A-42S	10.0	M42	4.5	220	142	98	136	65	31	39	131	229	65	95	230 - 450	10.0
A-48S	12.0	M48	5	220	142	97	136	75	31	39	132	229	69	95	294 - 585	15.2

FRENO LINKBOLT A

Safety factor 5:1

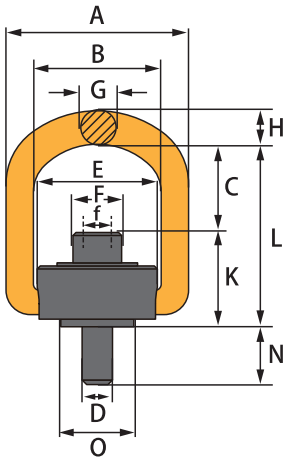

A [Hexagonal Hole Bolt] * Please check availability.

FRENO LINKBOLT compatible with hexagonal wrenches.

Product Code	WLL (t)	Bolt Size D	Pitch (mm)	Dimensions (mm)													Tightening Torque (Nm) Min - Max	Weight (kg)
				A	B	C	E	F	f	G	H	K	L	N	O			
A-8E	0.3	M8	1.25	60	42	32	40	13	6	8	11	29	61	14	24	8 - 15	0.25	
A-10E	0.5	M10	1.5	60	42	30	40	16	8	8	11	31	61	19	24	12 - 20	0.26	
A-12E	0.8	M12	1.75	89	57	52	51	18	10	13	17	43	95	19	37	18 - 29	0.81	
A-16E	1.6	M16	2	89	57	48	51	24	14	13	17	47	95	24	37	30 - 49	0.85	
A-20E	2.8	M20	2.5	126	82	71	80	30	17	19	23	63	134	32	51	49 - 78	2.6	
A-24E	3.7	M24	3	126	82	67	80	36	19	19	23	67	134	37	51	59 - 196	2.7	
A-30E	6.3	M30	3.5	179	117	92	111	45	22	27	32	90	182	50	73	108 - 294	7.2	
A-36E	8.0	M36	4	179	117	86	111	54	27	27	32	96	182	60	73	177 - 392	7.6	

* The f dimension is the facing width of the hexagonal hole.

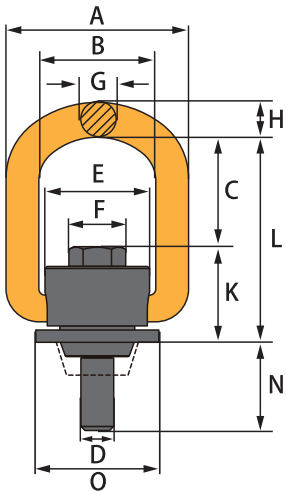

A [Seat Washer] * Please check availability.

Used for lifting secondary concrete products with countersinks on inserts.

Product Code	WLL (t)	Bolt Size D	Pitch (mm)	Dimensions (mm)													Tightening Torque (Nm)	Weight (kg)
				A	B	C	E	F	G	H	K	L	N	O				
A-16H	1.4	M16	2	89	57	54	51	24	13	17	47	101	43	60	49	1.0		
A-20H	2.8	M20	2.5	126	82	78	80	30	19	23	63	141	50	90	78	3.1		
A-24H	3.7	M24	3	126	82	76	80	36	19	23	65	141	60	90	196	3.2		

Corresponding Countersink Dimensions	Product Code	Top Ø (mm)	Bottom Ø (mm)	Depth (mm)
	A-16H	40	30	9 - 16
	A-20H	50	40	12 - 20
	A-24H	50	40	12 - 20

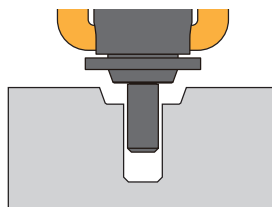

Please check countersink dimensions before sending us your product inquiry.

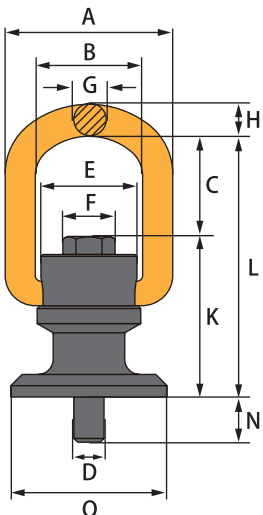

A [Wide Swing Angle] * Please check availability.

Moves 130° from the bolt mounting axis. Larger movement angle for a wider range of applications.

Product Code	WLL (t)	Bolt Size D	Pitch (mm)	Dimensions (mm)													Tightening Torque (Nm)	Weight (kg)
				A	B	C	E	F	G	H	K	L	N	O				
A-16K	1.6	M16	2	89	57	54	51	24	13	17	86	140	24	83	50	1.7		
A-20K	2.8	M20	2.5	126	82	78	80	30	19	23	114	192	34	103	80	4.5		
A-24K	3.7	M24	3	126	82	76	80	36	19	23	116	192	39	103	200	4.6		

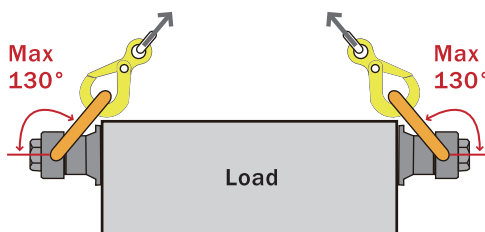

Caution: Make sure not to exceed the maximum movable link angle.